



**The fully-managed
solution to expand
endoscopy capacity**

The fully-managed solution to expand endoscopy capacity

Covid-19 has had a profound impact on endoscopy capacity in the UK. Restoring capacity to pre-COVID levels to manage the enormous backlog is among the key challenges facing providers in the NHS during the phase 3 recovery.

New COVID-minimised pathway requirements mean reinstating internal capacity to pre-COVID levels is all but impossible for many services. For many trusts, constraints such as limited physical infrastructure and staffing shortages limit full-scale recovery.

ICS and Lifecycle, two leading providers to the NHS, have joined forces to deliver modular, JAG-compliant endoscopy suites.

Delivered as a fully-managed service, it includes the physical facilities, equipment and a dedicated team to deliver a high-quality endoscopy service you can trust.

Call us today

To discover how we can build a solution that meets your endoscopy requirements in detail please contact:

Lifecycle Management Group

Johnathan Elsmore-Wickens on 07979 495986 or email: j.wickens@Lifecycle.co.uk

ICS Insourcing

Nicola Ellis-Webb on 07973 911222 or email: Nicola.elliswebb@insourcing.com



Independent Clinical Services

(ICS group) is the largest provider of clinical staffing in the UK and Europe. They place in excess of 21,000 nurses, doctors and allied health professionals in NHS and private hospitals every week. As such, they have unique capabilities to support delivery of services to local Trusts and across an entire Integrated Care System. Their clinical, operational and governance capabilities are well established and proven.

ICS is a trusted NHS elective care delivery partner, experienced in delivering a range of services, tailored to the needs of individual NHS organisations, including demand optimisation, clinical capacity and community services redesigned and delivered via innovative care delivery models.



Lifecycle Management Group

has been sourcing, financing and managing medical devices, including endoscopy systems, on behalf of NHS Trusts for more than 25 years. They have also been responsible for financing multi-million pound modular building solutions.

Lifecycle is currently retained by over 50 Acute NHS Trusts. They procure over 1000 contracts per annum and manage more than 3000 contracts on behalf of their NHS clients.

Responsible for the physical components of the project, financing and project management, Lifecycle is the ideal partner

Everything you need in a single managed service



A modular endoscopy facility, designed to your specification

The modular facility is a completely self-contained endoscopy facility



Fully JAG-compliant

The service will meet all relevant JAG guideline with bi-annual audits by an experienced JAG consultant



High-patient throughputs

The unit can be designed to facilitate high air exchanges to ensure quick turnaround of cases



A qualified team you can trust

Service delivered by JAG-accredited endoscopists and experienced endoscopy nurses & decontamination technicians



A fully-managed service

The service is delivered as a fully-managed, VAT-recoverable solution



7-day working

Service delivered 7-days per week across 3 sessions



Managing demand to minimise waiting lists

Our consultants can help you manage and reduce demand for endoscopy



11 endoscopy JAG points per session

Up to 33 JAG points delivered across 3 session days



Rapid deployment

From order to go-live in a matter of 12-15 weeks



Capital equipment options

Customer-led financial solution including revenue funding, off customer balance sheet



Acquisition via established framework

Multiple national framework awards provide a compliant route to market for NHS trusts wishing to procure the service



Seamless mobilisation

Designated project and account management teams ensure project is delivered on time and on budget



Introducing our self-contained, modular endoscopy unit

Our temporary modular endoscopy units provide flexible clinical capacity to meet the current challenge of delivering COVID-minimised activity from alternate premises. The units can be situated either on hospital premises or away from acute sites at appropriate community locations. They are designed to deliver JAG-compliant services with special attention paid to patient flow, segregation of sexes, privacy and dignity and safe decontamination practices.

Whether the proposed COVID recovery plan for your organisation involves insourcing or outsourcing of the clinical activity, these fully-integrated units support both models of delivery.

The units are appropriate for a broad range of routine GI and non-GI endoscopy procedures. We will work closely with you at the start of the engagement to ensure the layout is appropriately configured to support the type of activity to be commissioned.

GI Endoscopy:

The unit can facilitate the delivery of up to 33 Endoscopy JAG points per day. This includes routine diagnostics, 2WW, surveillance cases as well as bowel cancer screening.

Non GI Endoscopy:

The following activity can also be delivered from our modular facilities:

- Cystoscopies
- Bronchoscopies
- Hysteroscopies



N.B. The units can also be designed without the integrated decontamination facilities

A JAG-compliant facility designed to your own specification

- 1 Reception Area
- 2 Consult or Change Room
- 3 Procedure Room
- 4 Dirty Room
- 5 Clean Room
- 6 RO Plant
- 7 DDA Toilet
- 8 Staff Change Area
- 9 Staff Room
- 10 Store Room
- 11 Sluice Room
- 12 Recovery Suite
- 13 Consult/Discharge

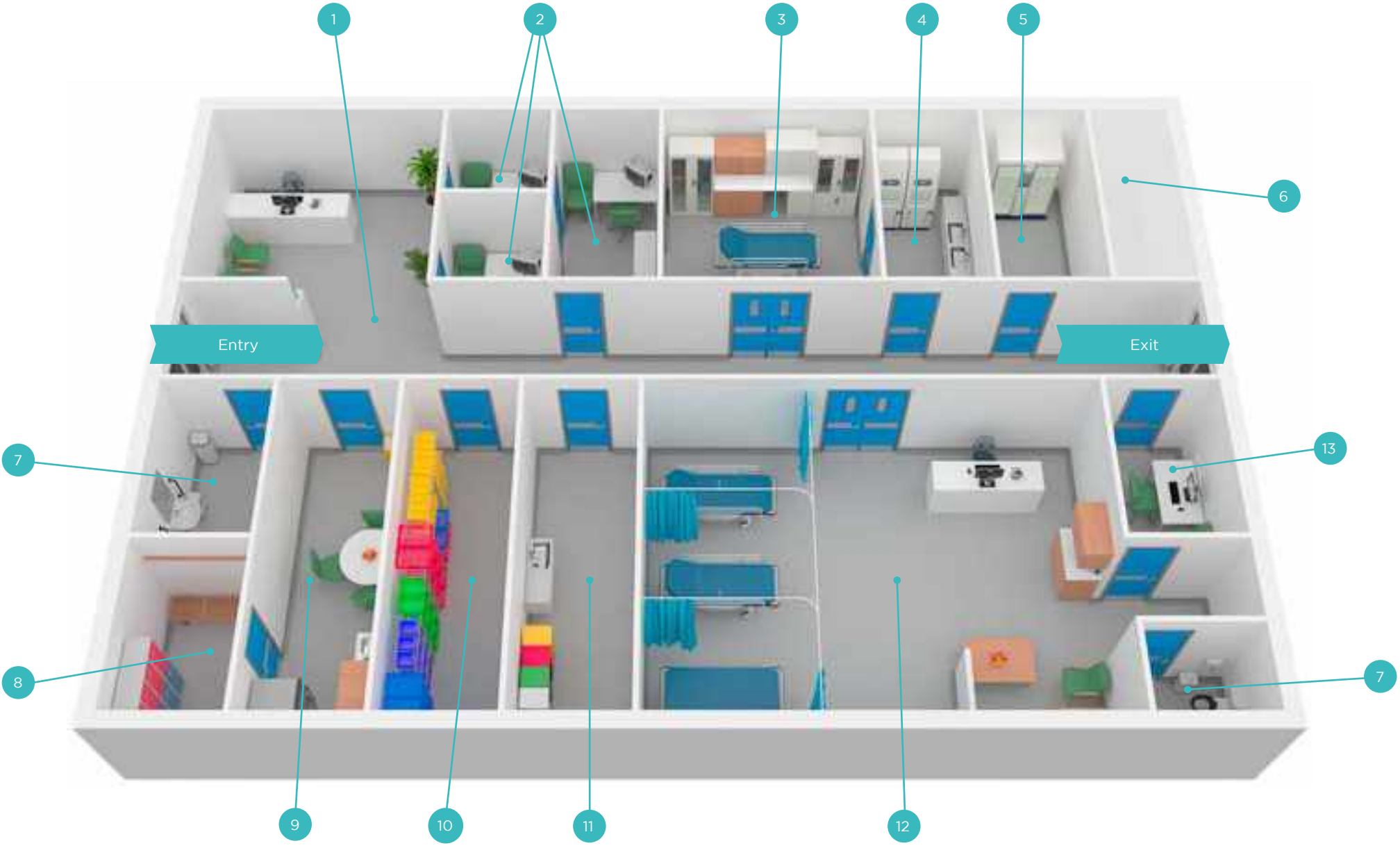

For illustration purposes only. Unit will be designed to your exact specification.

Fully equipped. Fully compliant

The endoscopy suite will include all the equipment necessary to deliver a high-throughput, high-quality endoscopy service. The equipment will be fully maintained in line with detailed JAG guidance.

The management and governance of the endoscopy suite will also follow all relevant standards, with detailed systems and processes in place.

The following equipment (Tier 1) will be supplied:

- Diathermy apparatus
- Smoke evacuation system
- Trolley stack
- Flexible endoscopes
- Flowmeters
- Aspirators
- Trolleys
- Instruments
- Computers
- Furniture
- Defibrillator
- Patient monitoring
- Decontamination equipment
- Reverse Osmosis System (if required)

The modular building will include the following:

- Fire Alarm, Emergency Lighting, Fire Extinguishers
- Intruder Alarm
- Curtain Tracks & Curtains
- Data Points
- Heat/cool air-conditioning and ventilation
- Air exchanges/Negative air pressure
- Ramp and Steps, Doors and partitions
- All modules with windows and external doors as appropriate
- All sockets, outlets, spurs etc
- HTM compliant luminaires and bulkhead lights
- HTM compliant medical basins, toilet, basins, water heaters and IPS panels
- Capped and covered beech effect slip resistant vinyl to floor

Services designed to maintain compliance with CQC, JAG and Information Security Standards.

- We can deliver a CQC registered service with designated Registered Manager
- Service designed and audited by independent JAG consultant
- NHS.net accounts
- ICS Group ISO 27001
- IG toolkit & Cyber Essentials certification
- Caldicott Guardian and Data Protection Officer



A first class endoscopy service

Our flexible service model is able to support both the operational management as well as the clinical delivery of your endoscopy services.

We will work with you to create a bespoke model that suits your local requirements

- A modular endoscopy unit
- Operate seven days a week
- All associated staff
- Associated equipment and consumables including scopes
- Integrated decontamination unit
- The provider will link into the existing pathology department
- Ownership of the project mobilisation phase to ensure achievement of key milestones
- Designated account manager and clinical leads who focus on service integration
- Documented workflows with sustained focus on patient experience
- Involvement as necessary in Endoscopy User Group and MDT meetings
- Clear framework for achievement of robust service governance
- Unrivalled performance monitoring and reporting
- Delivery of local access standards and monitoring of performance against diagnostic targets
- Booking of patient appointments and implementation of initiatives for the reduction of DNA rates
- Management of COVID-minimised procedures such as isolation of patients, swabbing and post-procedure symptom audits
- Monitoring of clinician performance against national standards
- Monitoring of patient outcomes
- Management of incidents and complaints



Planned deployment of a complete solution

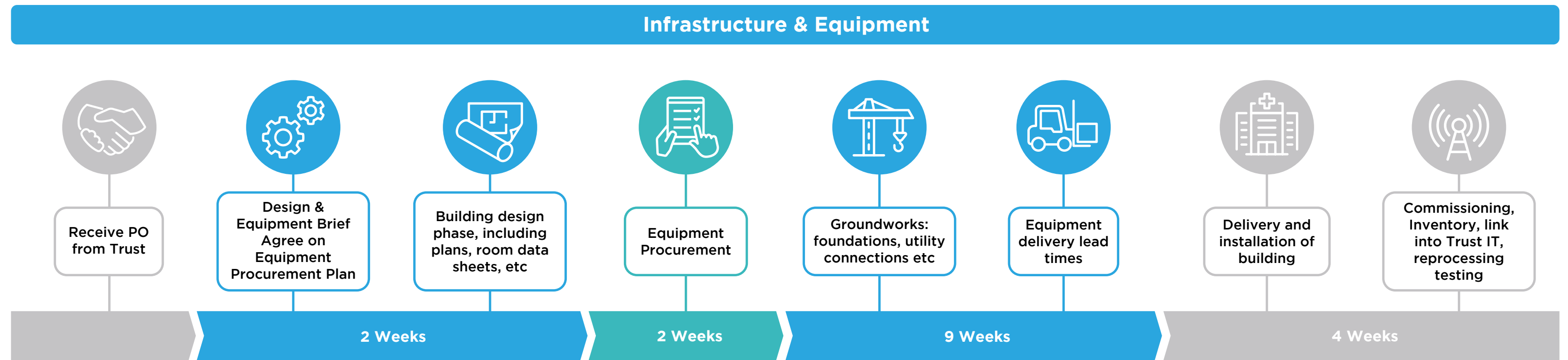

Prince 2 Project Management
Following approval of proposal and framework 'call off', our clinical operations team will initiate our project mobilisation plan to ensure a consistent approach to achievement of key milestones

Stakeholder briefing
We will dive into the full scope of your requirements. We will speak with all your internal stakeholders to ensure maximum engagement

Service mapping

- We will conduct a thorough mapping of your service to establish the best approach to take to service integration
- Review of local referral guidelines
- Review of clinical care pathways
- Review of local policies and procedures
- Review of local documentation
- Creation of a detailed Operations Manual

Workforce optimisation
We will select the most appropriate clinical team for your service, ensuring sub-specialty level expertise where necessary as well as a full scope of practice for each clinician in the service.

Service Integration
We select two band 7 nurses to act in the capacity of Service Delivery Lead on the frontline and both nurses play an active role in the mobilisation and integration of the new service as well as ongoing monitoring of our performance. You will be notified of all staff attending the service at least 2 weeks in advance and we guarantee at least 50% continuity of staff

Clinical Service Delivery

The flexible, off balance sheet solution that is VAT recoverable

Off-balance sheet, VAT recoverable managed service

The service is structured as a Managed Service with ICS acting as the principle contractor. There are no capital outflows required as the entire service is funded on a revenue cost basis.

As a fully-managed clinical service, the entire project will be off-balance sheet. We will support clients to ensure they are able to secure approval for the service to be VAT recoverable and off balance sheet.

Acquisition via established framework

These services can be procured directly from the NHS Shared Business Services Outsourcing Framework. We'll happily guide you through the process for calling off the project from the framework.

Call us today

To discover how we can build a solution that meets your endoscopy requirements precisely, contact:

Jonathan Elsmore-Wickens

Commercial Director
Lifecycle Management Group

07979 495986

j.wickens@lifecycle.co.uk

Nicola Ellis-Webb

Clinical Operations Director
ICS Insourcing

07973 911222

nicola.elliswebb@icsinsourcing.com

